



# CONCRETE GRADE RINGS

## 24" id / 34" od

Available Sizes 24" id / 34" od	Weight Approx.
3" h Concrete Grade Ring	80 lbs.
6" h Concrete Grade Ring	160 lbs.
12" h Concrete Grade Ring	320 lbs.

Conforms to ASTM Standards.

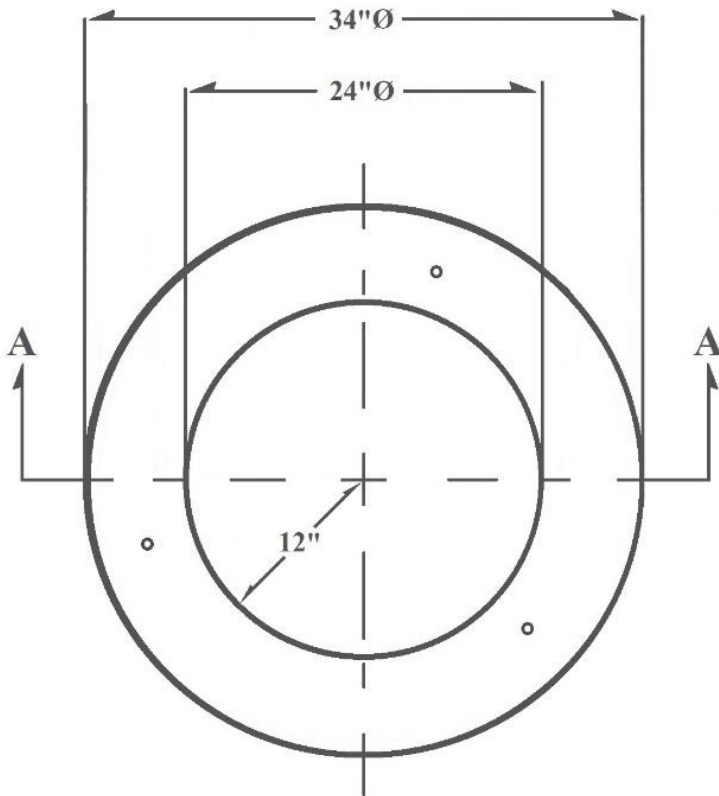

Top View

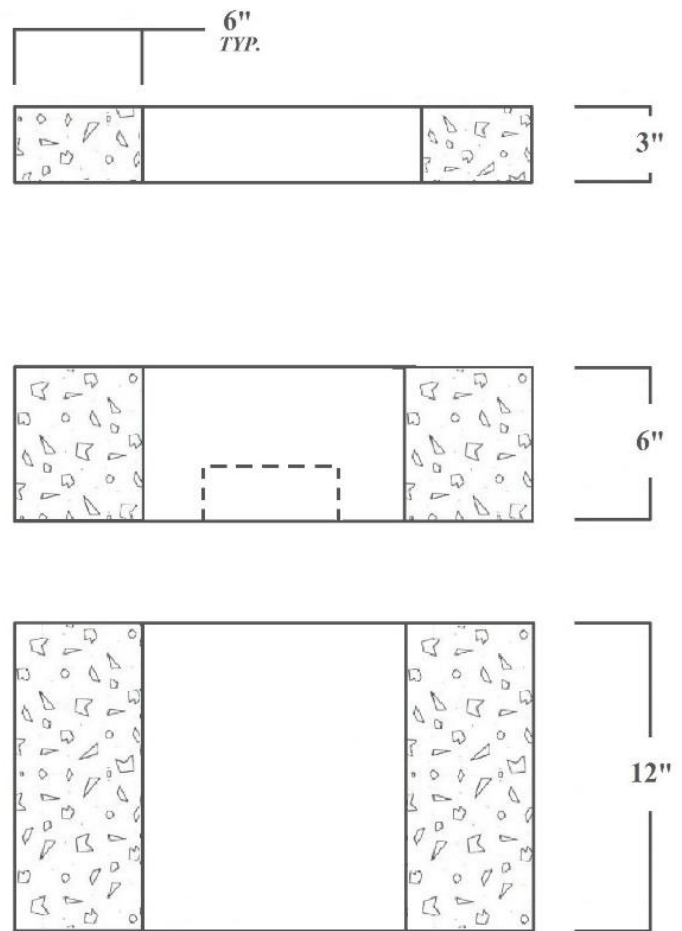

Cross Sections A-A

3309 Sebastopol Road  
 Santa Rosa, CA 95407  
 P (707) 542-2762  
 F (707) 542-3901